

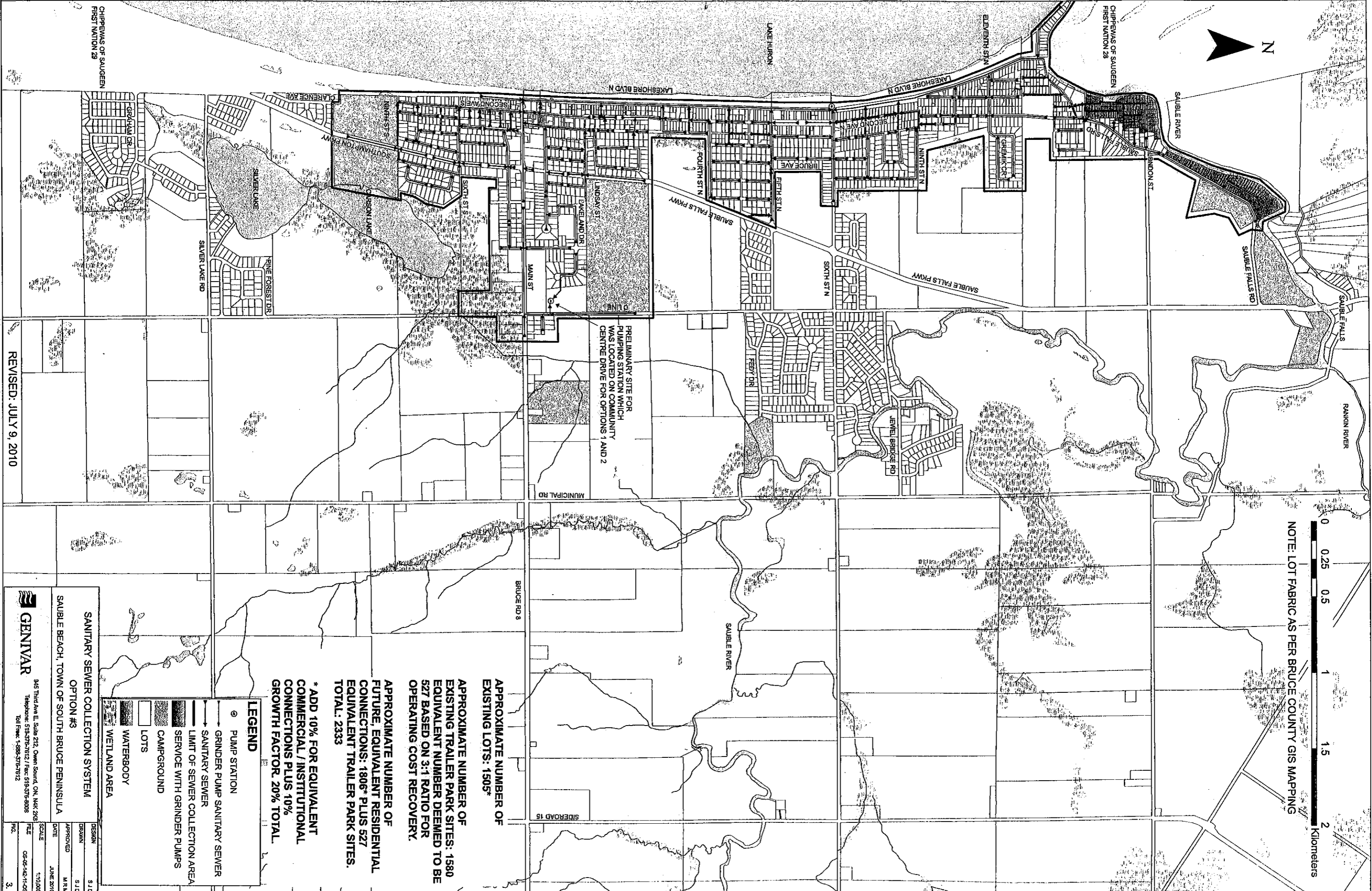

NOTE: LOT FABRICAS PER BRUCE COUNTY GIS MAPPING



PRELIMINARY SITE FOR PUMPING STATION WHICH WAS LOCATED ON COMMUNITY CENTRE DRIVE FOR OPTIONS 1 AND 2

APPROXIMATE NUMBER OF EXISTING LOTS: 1505*

APPROXIMATE NUMBER OF EXISTING TRAILER PARK SITES: 1580 EQUIVALENT NUMBER DEEMED TO BE 527 BASED ON 3:1 RATIO FOR OPERATING COST RECOVERY.

APPROXIMATE NUMBER OF FUTURE EQUIVALENT RESIDENTIAL CONNECTIONS: 1806* PLUS 527 EQUIVALENT TRAILER PARK SITES. TOTAL: 2333

* ADD 10% FOR EQUIVALENT COMMERCIAL / INSTITUTIONAL CONNECTIONS PLUS 10% GROWTH FACTOR, 20% TOTAL.

LEGEND

- ⊙ PUMP STATION
- GRINDER PUMP SANITARY SEWER
- SANITARY SEWER
- LIMIT OF SEWER COLLECTION AREA
- SERVICE WITH GRINDER PUMPS
- ▨ CAMPGROUND
- ▨ LOTS
- ▨ WATERBODY
- ▨ WETLAND AREA

SANITARY SEWER COLLECTION SYSTEM
OPTION #3
SAUBLE BEACH, TOWN OF SOUTH BRUCE PENINSULA

GENIVAR
945 Third Ave E, Suite 212, Owen Sound, ON, N4K 2N6
Telephone: 519-575-7512 / Fax: 519-575-8008
Toll Free: 1-888-575-5712

DESIGN	S.J.D.
DRAWN	S.J.D.
APPROVED	M.R.M.
DATE	JUNE 2010
SCALE	1:100.00
FILE	GS-05-142-11-05
FIG.	3

REVISED: JULY 9, 2010

CHIPPENAS OF SAUGEEN
FIRST NATION 29

CHIPPENAS OF SAUGEEN
FIRST NATION 28